



MRT 715.320

Technical Sheet



Lever hoist | 3.200 | MRT

- Cast steel safety latches** Increased durability with heavy duty safety latches secured with Allen screws and locknuts.
- Caged needle bearing design** Increases efficiency and promotes smooth operation extending the work life of the hoist.
- Compact design** Smaller body and lightweight design for low headroom applications and use in confined areas.
- Patented fused brake design, proven durability that increases safety**
- Weston style dual pawl brake system, double pawl design increases safety**
- Unique hand wheel & knob design, No preload required**
- Alloy steel hook, industrial rated hooks rotate 360 degrees for easy rigging**

Item code	WLL kg	A mm	B mm	C mm	D mm	E mm	F mm	G mm	H mm	I mm	Weight
715.320	3.200	200	120	52	395	410	114	34	50	27	13.6 kg

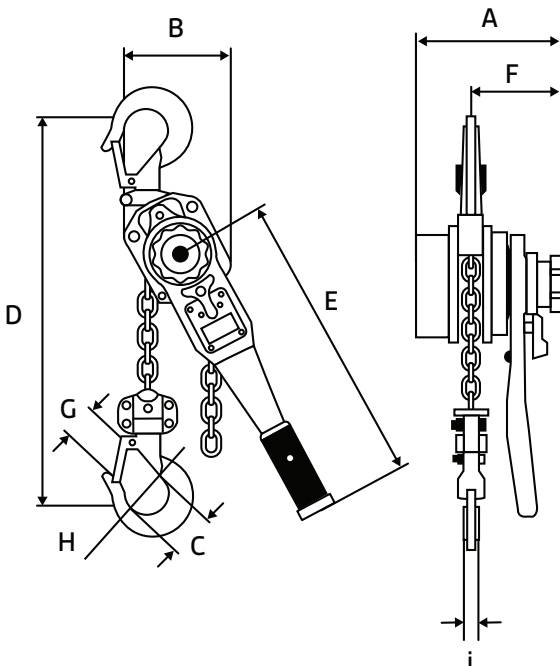

Falls of chain	1
Norm hoist	NEN-EN-ISO 12100-1/2, NEN-EN 818-7, NEN 2138
Hoist chain	10x28mm Electro-Galvanized - T-hardened
Norm hoist chain	DIN-EN 10204 EN 818-7
HS code	8425190000



Mitari Hijstechniek BV - The Netherlands - De Maas 40 - 5684 PL Best

www.mitari.nl - info@mitari.nl